

**MAXIMUM CONTENT OF BURNING OILS:**  
**PART NO. 21035320A-B 22, 24, 1.75 15° DC PART I X X**  
**MAX LOAD APPROX MAX ELEVATE 805 0 10A XXIX**  
**(ACCORDING TO CUSTOMER REQUIREMENTS,**  
**TYPE/CLASS/STI TYPES MAY VARY,**  
**THE WEIGHT OF WEIGHTS(0.200)**

- ◆ Dynamic Unbalance
- 1、A ≤ 30G
  - 2、B ≤ 30G
  - 3、A+B ≤ 50G

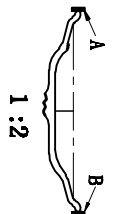

- Technical notes:**
1. Compliance with US Federal Motor Vehicle Safety No. 130
  2. Durability Test(SAE J2017)
  - Cornering Fatigue Test
  - ★ -Loading Mode: 90°
  - Load: 2117 ± 87kg. m
  - Cycle: 300000
  - ★ Radial Fatigue Test
  - Load: 12000 ± 940kg. m
  - Cycle: 100000
  3. . Tyre: 388/60R22. 5, radius: 0.400m
  4. Valve balance testing
  - standard: max 200kg. cm
  5. Valve: 40MS-00/TBSSSE
  6. Valve nut
  - torque: 80-120N.M (8. 95-14. 64m. m)
  7. Valve cap: TRVC3
  8. Two pieces nuts
  - 123-1. 5, torque: 62/60kg. m
  9. Tolerance
- Dimensional Tolerance ±1**  
**Angle Tolerance ±1°**  
**Radius Tolerance ±1**

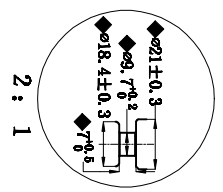
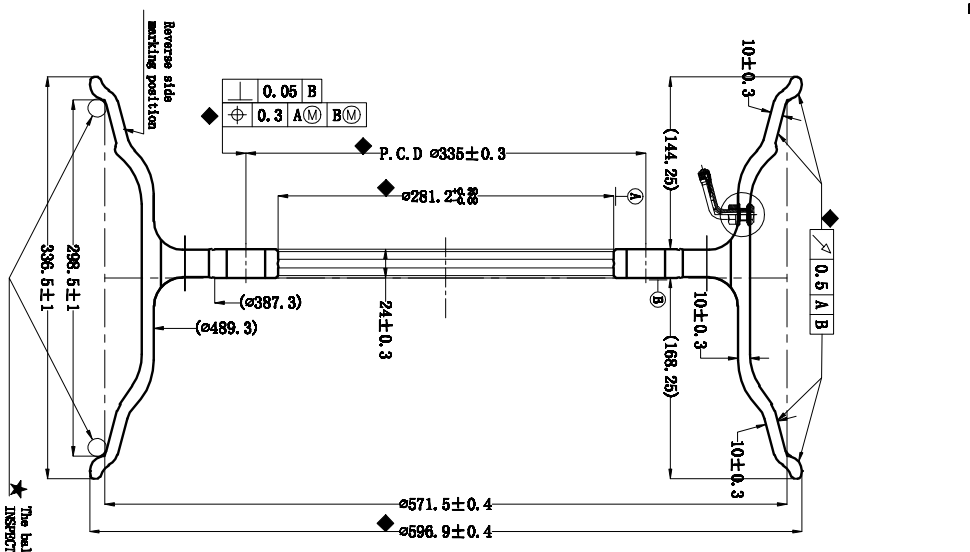

★ The ball rib seat in diameter INSPECT CAREFULLY BEING AHEAD (0.05 IN/MSI DISC TIPS FOR TIRE AND KIM ASSOC SPECIFICATION

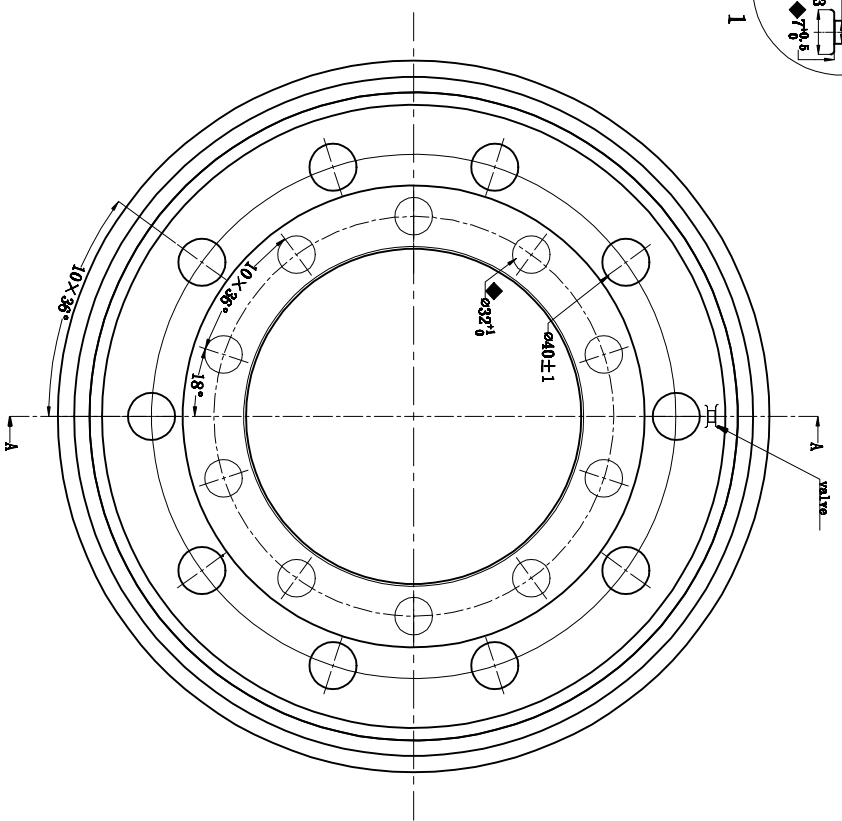

Changed the level	Place a few number	Changed notification	Changed content	Signature	Date

Important features	◆
Key Features	★

Design	GT090-20A - 22, 24, 1.75	Product picture	GT090-20A - 22, 24, 1.75	Drawing No.	21035320A-B
Procture	ET: INSERT/OUTSER	Vehicle model	0/24	Revision	A/1
Classification		Surface treatment	Material/polishing	Weight (Theoretical)	24.8kg
Technology		Material	6061-76	Percentage	1:1
Standardization		Projection marks		A total of one	The first page
Notification					
Date					

Qingdao J&G